

QPD4-80-500-30-S

4-Way, 0.08~0.5GHz

Features:

- * Small Size
- * Low Insertion Loss

Applications:

- * Amplifiers
- * Mixers
- * Antennas
- * Laboratory Test

Electrical

Frequency:	0.08~0.5GHz
Insertion Loss:	1.5dB max.
Input VSWR:	1.25 max.
Output VSWR:	1.20 max.
Isolation:	20dB min.
Amplitude Balance:	0.2dB max.
Phase Balance:	$\pm 3^\circ$
Impedance:	50 Ω
Average Power:	30W max. 2W max. as combiner

Mechanical

Size* ¹ :	170*110*12mm 6.693*4.33*0.472in
Weight:	500g
Connectors:	SMA Female
Mounting:	4- Φ 4.4mm through-hole

[1] Exclude connectors.

Environmental

Operation Temperature:	-45~+85°C
------------------------	-----------

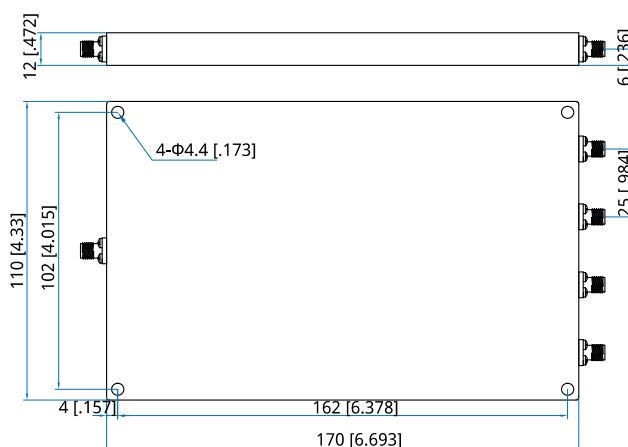
Outline Drawings

Unit: mm [in]

Tolerance: $\pm 0.5\text{mm}$ [$\pm 0.02\text{in}$]

How To Order
QPD4-80-500-30-S

Customization is available upon request.